

MICROFILMED

Note: Improvements on this lot are not in a flood hazard area.

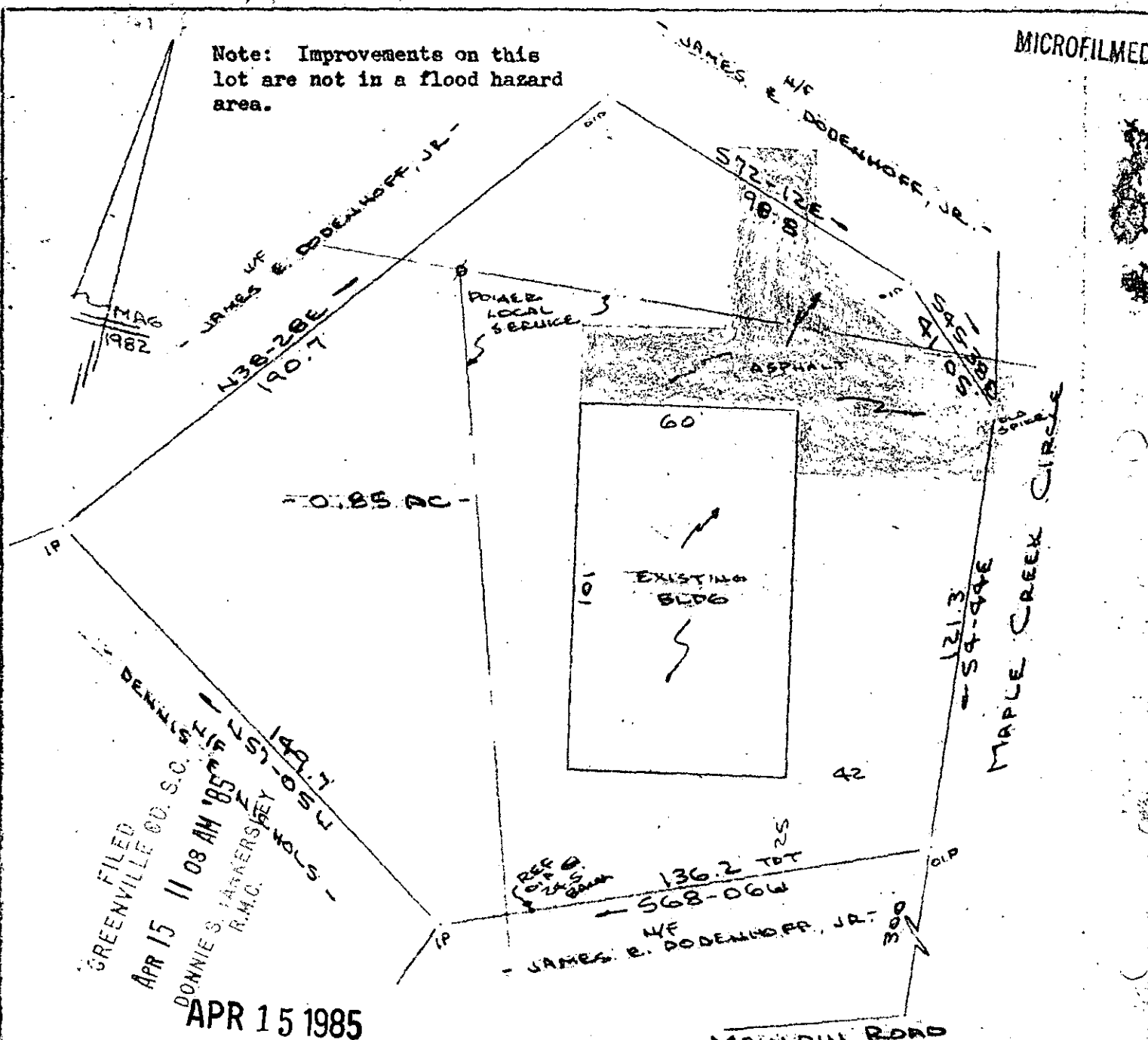

FILED
 GREENVILLE CO. S.C.
 APR 15 11 08 AM '85
 DONNIE'S TARKERS
 R.M.C.
 APR 15 1985

11M-1
 30821

PROPERTY OF
 B. G. CLEVELAND
 NEAR MAULDIN, GREENVILLE CO., S.C.
 SCALE 1" = 40' 3 APR 1985

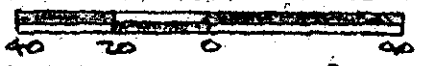

This is to certify that on the 3rd day of April, 1985, I surveyed the property shown on this plat, being known as 0.85 acres on plat of JAMES E. DODENHOFF, JR. recorded in the RMC Office Greenville County, S. C., in Plat Book "5 - 2" at Page 54; and that the property lines, walls and buildings are as shown hereon, and that the walls and buildings located on said lot do not encroach or project on adjacent street or property, and that no adjacent walls or buildings encroach or project on said premises, and no power lines cross this property except as shown hereon.

CAROLINA SURVEYING CO.
 112 Manly St.
 Greenville, S. C.

R. B. Bruce
 R. B. Bruce, RLS # 1952

Recordable Plat